

Application Pack

Please read below all the important information regarding your application.

The City of Kalamunda is proudly presenting the City of Kalamunda Art Awards 2026.

Held annually at the Zig Zag Gallery, the Kalamunda Art Awards is a supportive arts prize that will showcase a diverse range of multi-disciplinary artworks from talented artists around Western Australia.

This is an open exhibition inviting all artists to apply and will showcase artworks by established and emerging artists from across Western Australia.

Please read below all the important information regarding your application.

Key Dates

- Call Out: 13 April – 3 May
- Entries close: Midnight, Sunday 3 May
- Shortlisted artists notified: by 5pm, Tuesday 5 May
- Artwork deliveries: 10am – 4pm, Tuesday 2 June
- Opening Event: Saturday 6 June 2026
- Exhibition dates: 6 June – 28 June
- Announcement of People's Choice Award winner: 29 June
- Collection of unsold work: 10am - 4pm, Monday, 29 June

Exhibition Information

Approximately 65 pieces will be short-listed.

The Gallery will have a pre-selection process which will involve selecting pieces based on the following criteria:

- Conceptual rigor
- Technical ability
- Originality or innovation
- Overall presentation

The total prize pool will be \$5,000.

All unsold artworks must be collected between 10am - 4pm, Monday, 29 June.

Entries are limited to one artwork per artist.

Prices, titles and other entry details cannot be altered after the entries close.

No late entries will be accepted.

How to submit your image

Please attach 1 image of the whole artwork with your application.

The image should be supplied as a JPG format, smaller than 500KB.

The image file name should have the following: Artist Name, Artwork Title, Year. For example: Mary Jones, Albany, 2025.

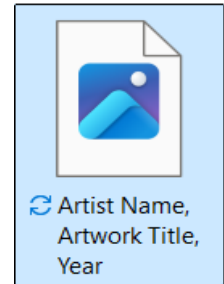

Payment and Entry Form

Send your completed entry form to: zzgallery@kalamunda.wa.gov.au with your image attached, before the due date.

Only works that are shortlisted for exhibition will be required to pay an exhibition fee.

Fees are payable on the day of delivery at the Visitor Centre.

How to prepare your artwork for delivery

If successful, we will inform you of the delivery day and time via email and you will be invited to bring your artwork to the gallery at a specific time and day.

Please make sure your work is prepared for display, with a robust frame and two D-hooks that will ensure we can hang it in our gallery system.

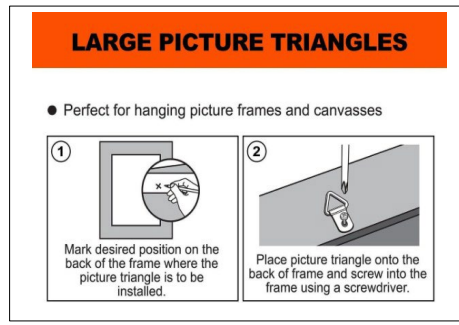

Award categories	Prize Amount
Overall Winner	\$3,000
Painting and 2D Award	\$500
Sculpture and 3D Award	\$500
Environmentally Aware Award	\$500
People's Choice Award	\$500
Total prize pool	\$5,000

Terms and Conditions

1. An exhibition fee of \$30 will apply to each work shortlisted for the exhibition. Entrants whose work is not shortlisted will not be required to pay an exhibition fee.
2. All entrants must complete the Competition Entry Form.
3. Entrants must submit one high-quality images (300dpi – 500dpi) of their artwork with their application form.
4. Entries are limited to one artwork per artist only. All works are eligible for the overall prize.
5. Artists over the age of 14 are invited to submit work for the Kalamunda Art Awards.
6. The artwork must be an original work of the artist and not contravene any copyright law.
7. All media welcome, including and not limited to painting, drawing, printmaking, sculpture, mixed media, and photography.
8. All pieces must be for sale. These will be retained on display until the end of the exhibition period.
9. All artworks must be suitably presented and ready for exhibition. Any work not fulfilling this requirement will be returned to the exhibitor.
10. 2D works are not to exceed 1000 x 1000 mm or weigh more than 15kg.
11. All 2D works must be framed for display in our gallery using two D-rings. Photographic clip frames, single string cords, wires or unframed works will not be accepted.
12. 3D works are not to exceed more than 15kg and not inhabit a footprint of more than 1000 x 1000 mm (square).
13. The Zig Zag Gallery will add 30% commission on all sales.
14. The work must be clearly labelled with your name, contact details, title and price fixed securely to the artwork.
15. Entrants agree to digital images being used for non-profit promotional purposes and captioned with the artist's name and artwork title.
16. Administration of sales and payment to artists may take up to four weeks after the closing of the exhibition.
17. Entrants exhibit at their own risk and will not hold the organizers, its officials, volunteers, employers, agents and public servants, responsible for any claims of whatever kind or nature to any person or to any property arising out of or in conjunction with the Kalamunda Art Awards and the City of Kalamunda.
18. All artworks will be judged and undergo a pre-selection process. The judges' decision will be final, and no correspondence will be entered into.
19. Sales are made for the duration of the award exhibition, during normal Gallery opening hours.
20. Sale of Artworks will require the artist to supply the Gallery with banking details. Please note that the administration of sales and payment to artists may take up to four weeks after the closing of the exhibition.

ENTRY FORM

Personal Details

Entrant's Full Name:

Preferred Artist's Name (if different to above):

Artist's year of birth:

Address: State: Postcode:

Contact Number: Email:

Artwork Details

Title of Artwork:

Medium: Year created:

Dimensions: (Width x Height x Depth in millimeters):

Does your work require a plinth? Yes / No

Price (excluding commission and GST) \$

I wish to be considered for the Environmentally Aware Prize Yes / No

Inclusivity

I identify as (tick as many that apply to you):

CALD

LGBTQIA+

Person with Disability

First Nations

Youth (aged 14-25)

Emerging Artist

None of the above

Declaration

I declare that the artwork entered in the Kalamunda Art Awards 2026 is my own original work and that I have read, understood and accept the TERMS & CONDITIONS of this competition.

Name:

Signature:

Date:

Please send through a copy of this application with a clear image of your artwork to zzgallery@kalamunda.wa.gov.au.