

**MODIFIED OUTLINE DEVELOPMENT PLAN
HIGH WYCOMBE URBAN AREA U2**

The Western Australian Planning Commission resolved on 9 October 2012 to endorse the modified Outline Development Plan as a guide for subdivision and development within the locality.

Signed for and on behalf of the Western Australian Planning Commission

an officer of the Commission duly authorised by the Commission pursuant to section 24 of the Planning and Development Act 2005 for that purpose in the presence of

P. Curran Witness
10-10-2012

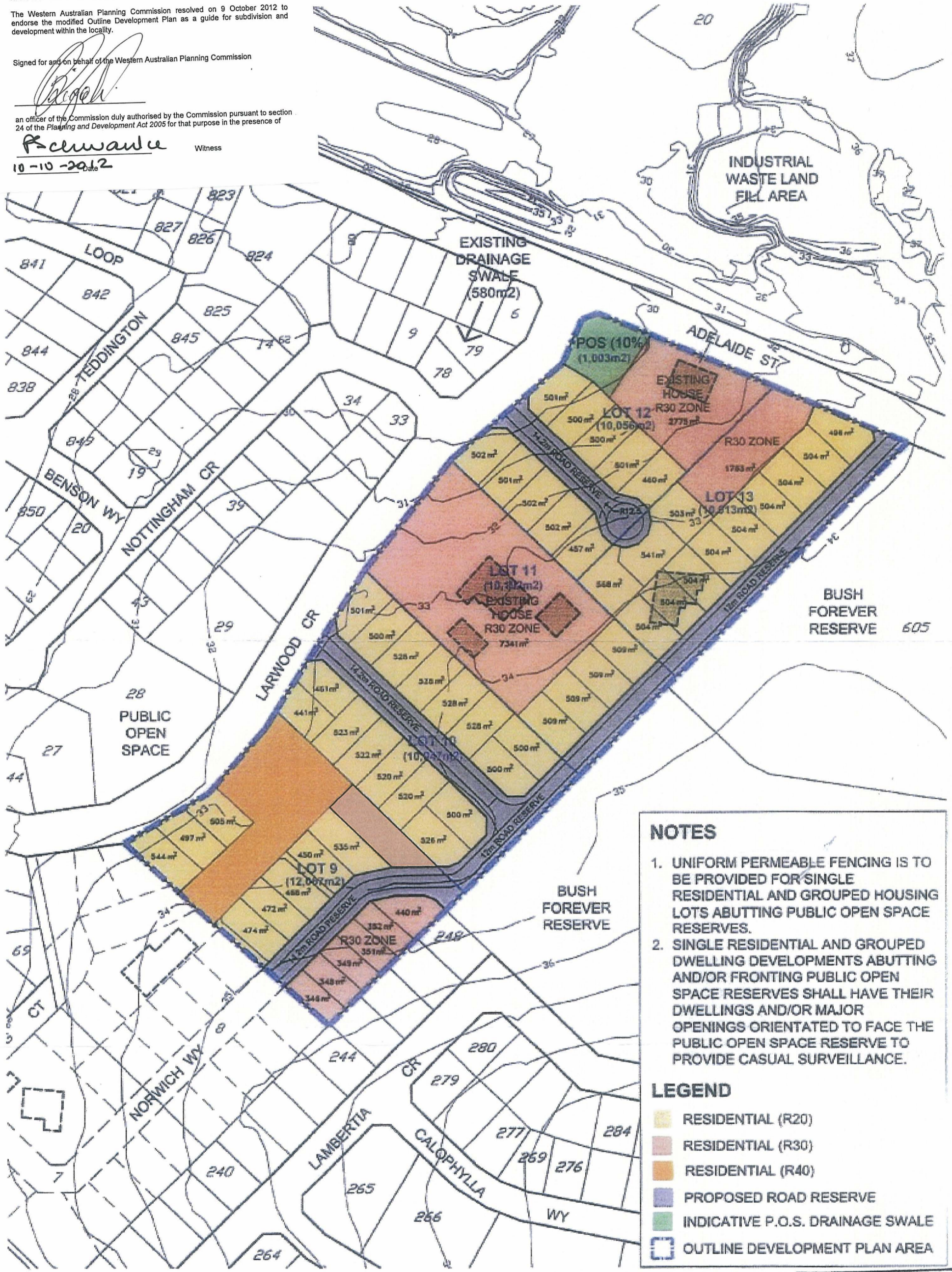

NOTES

1. UNIFORM PERMEABLE FENCING IS TO BE PROVIDED FOR SINGLE RESIDENTIAL AND GROUPED HOUSING LOTS ABUTTING PUBLIC OPEN SPACE RESERVES.
2. SINGLE RESIDENTIAL AND GROUPED DWELLING DEVELOPMENTS ABUTTING AND/OR FRONTING PUBLIC OPEN SPACE RESERVES SHALL HAVE THEIR DWELLINGS AND/OR MAJOR OPENINGS ORIENTATED TO FACE THE PUBLIC OPEN SPACE RESERVE TO PROVIDE CASUAL SURVEILLANCE.

LEGEND

- RESIDENTIAL (R20)
- RESIDENTIAL (R30)
- RESIDENTIAL (R40)
- PROPOSED ROAD RESERVE
- INDICATIVE P.O.S. DRAINAGE SWALE
- OUTLINE DEVELOPMENT PLAN AREA

DEPARTMENT OF PLANNING
12 JUN 2012
FILE