

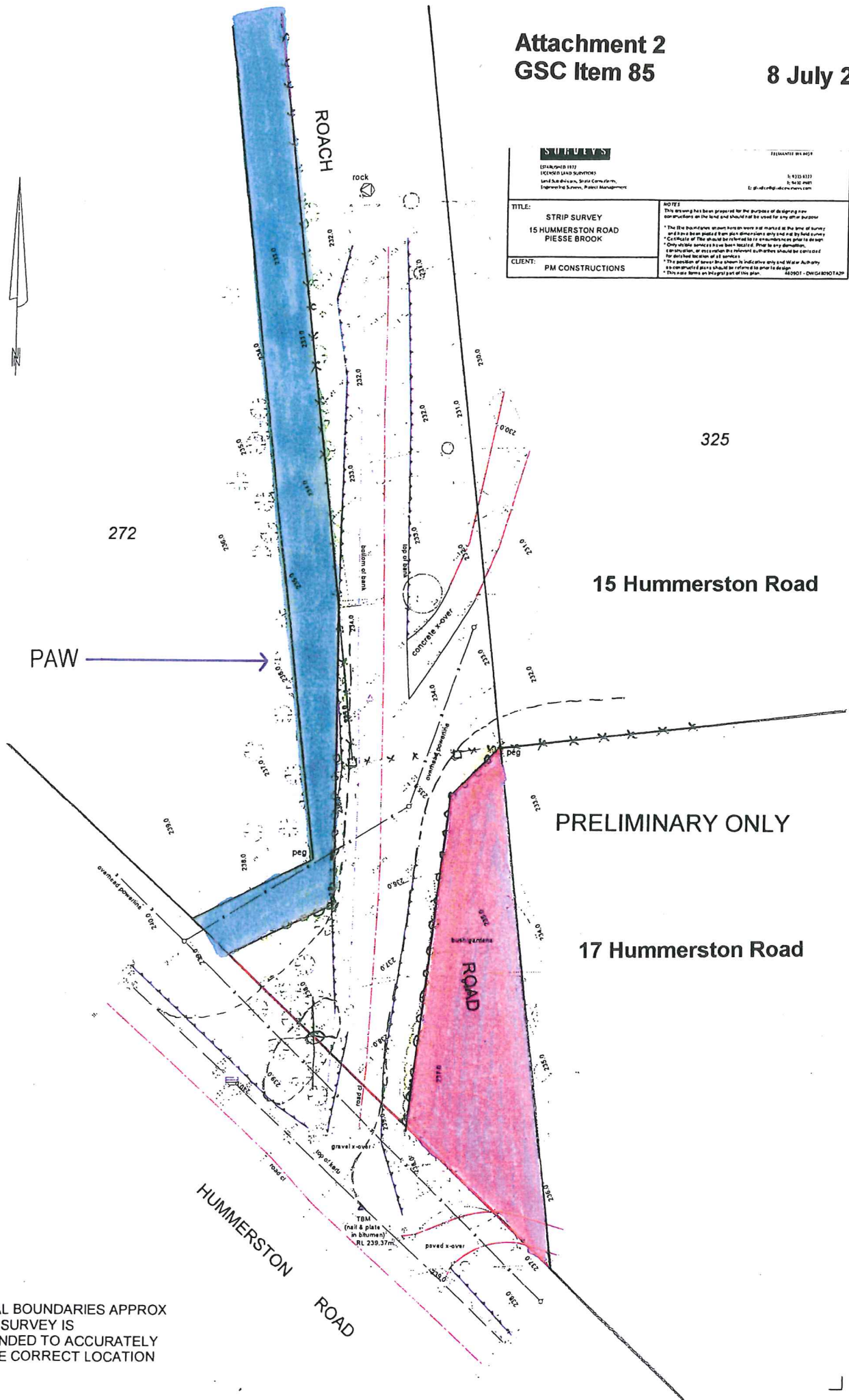

<b>SUBJECTS</b>		<small>TELEPHONE BY AREA</small>
<small>ESTABLISHED 1977 LICENSED LAND SURVEYORS Land &amp; Air Services, Spatial Computation, Engineering Surveys, Project Management</small>		<small>6 433 4333 6 43 62 4047 E: gtd@pml.co.nz</small>
<b>TITLE:</b>	<b>NOTES</b>	
STRIP SURVEY 15 HUMMERSTON ROAD PIESSE BROOK	<p>This drawing has been prepared for the purposes of designing new construction on the land and should not be used for any other purpose.</p> <p>The boundaries shown here are those as marked at the time of survey and it is the responsibility of the client to ensure that they are correct. The client should be advised that the survey is only as good as the data provided to the surveyor. Only visible boundaries have been shown. Prior to any demolition or construction, an excavation to determine the location of the boundaries should be carried out for the location of all services.</p> <p>The position of service lines shown is indicative only and Water Authority or a competent person should be referred to prior to design.</p> <p>This site forms an integral part of the plan.</p>	
<b>CLIENT:</b>	PM CONSTRUCTIONS	



272

325

PAW →

15 Hummerston Road

PRELIMINARY ONLY

17 Hummerston Road

HUMMERSTON ROAD

NOTE:  
CADASTRAL BOUNDARIES APPROX  
ONLY AND SURVEY IS  
RECOMMENDED TO ACCURATELY  
DETERMINE CORRECT LOCATION

rock

bottom of bank

top of bank

concrete cover

bush gardens

TBM  
(nail & plate  
in bitumen)  
RL 239.37m

gravel cover

top of bank

row of trees

road of

road of

road of

road of

road of

road of

road of

road of

road of

road of

road of

road of

road of

road of

road of

road of

road of

road of

road of

road of

road of

road of

road of

road of

road of

road of

road of

road of

road of

road of

road of

road of

road of

road of

road of

road of

road of

road of

road of

road of

road of

road of

road of

road of

road of

road of

road of

road of

road of

road of

road of

road of

road of

road of

road of

road of

road of

road of

road of

road of

road of

road of

road of

road of

road of

road of

road of

road of

road of

road of

road of

road of

road of

road of

road of